

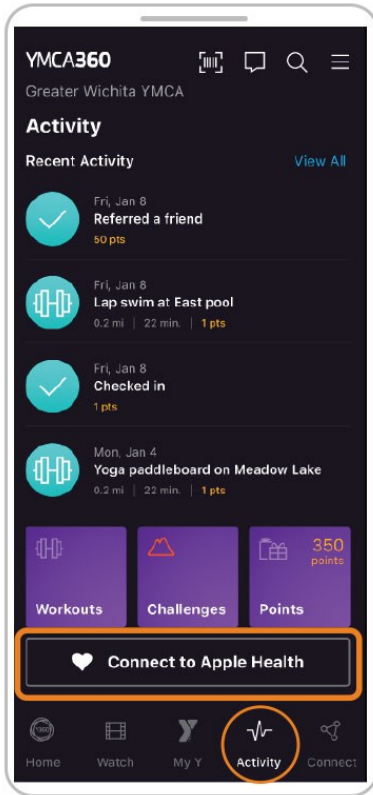

YMCA360 MOBILE APP

How to Connect a Wearable/Device



Select the Activity Page and click "Connect to Apple Health" or "Connect to Google Fit" depending on the device.

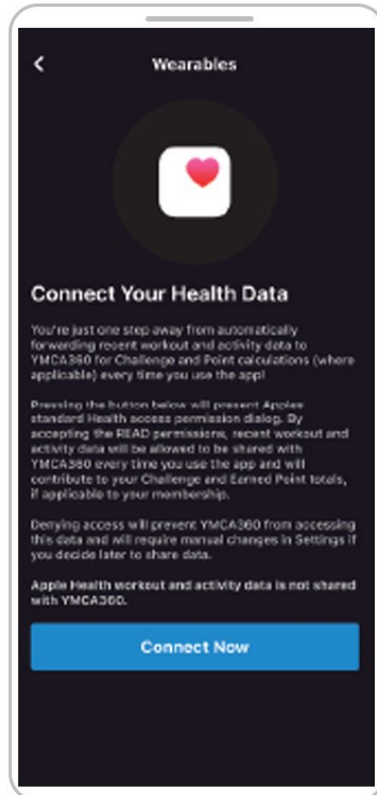

Read the information and if you want to proceed, click on the blue button to grant access in your settings.

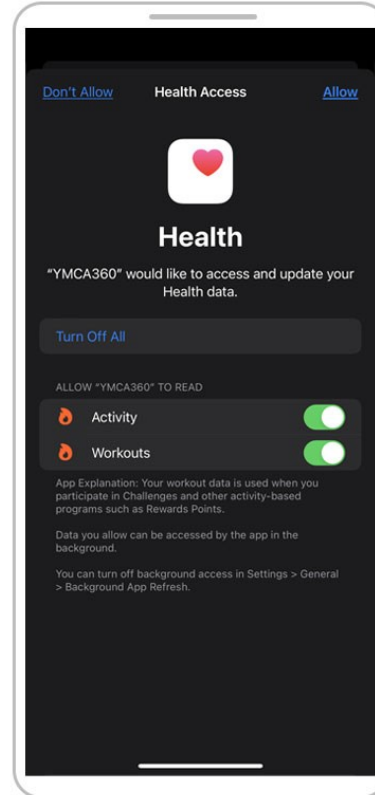

Toggle what information you want to allow YMCA360 to share with your YMCA360.

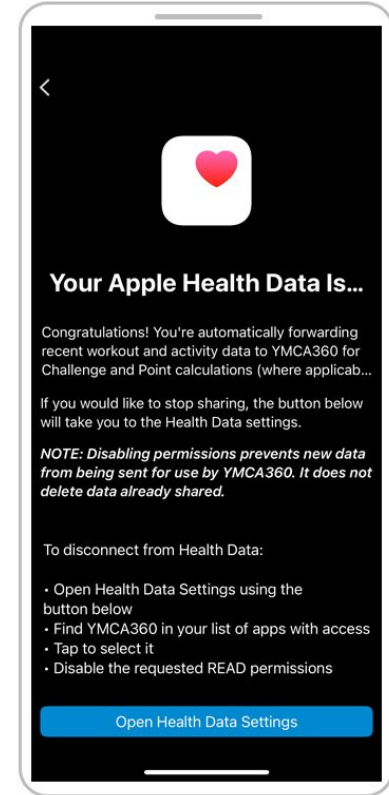

Once successfully synced and you can edit the access any time by clicking the blue button.

DOWNLOAD THE APP

Earn points for rewards in the YMCA360 app. Download for iOS and Android.



Apple Store



Google Play



FOR YOUTH DEVELOPMENT®
FOR HEALTHY LIVING
FOR SOCIAL RESPONSIBILITY